

Storage units **Lampo Open**

Modularity

MODULARITY WITH MODULAR COVER

heights

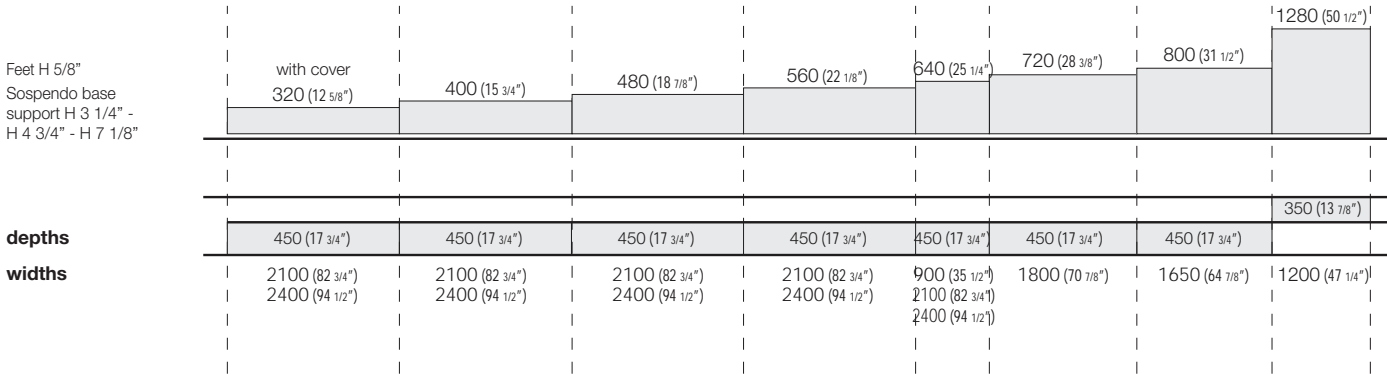

MODULARITY WITH FRAME 4 SIDES

heights

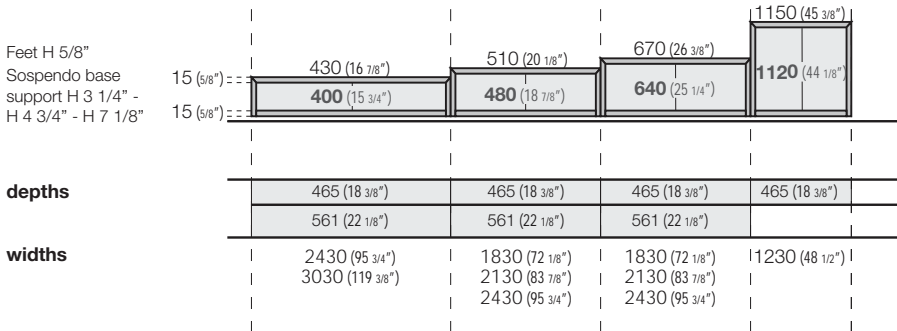

LAMPO
OPEN

Open sideboards are made up of standard Lampro units with 7/8" thick fronts and open units with 5/8" thick structure and 45° joints. Sideboards with tops and frames are higher (5/8" and 1 1/4" respectively) than sideboards with finished modular covers. The types of opening available are shown with a code next to the fronts.

Storage units **Lampo Open**

STRUCTURAL FEATURES

OPEN SIDEBOARDS WITH UPPER OPEN UNITS WITH EXPOSED COVER

Sideboards with exposed upper Open units CANNOT BE FINISHED WITH FULL SUPERIMPOSED TOPS. The construction with finished modular cover or finished cover (single) and opening with Minimal profile keeps the front panels bound to the structures and aligned with the Open units.

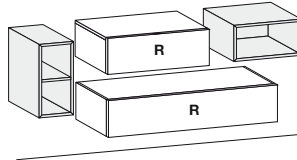
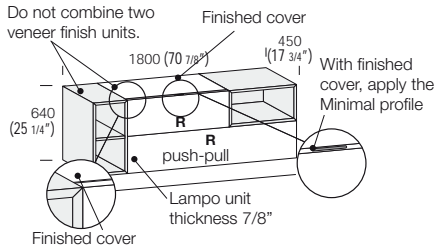

OPEN unit with continuous grain

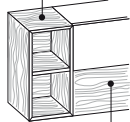

LAMPO front panel with horizontal grain

GRAIN DIRECTIONS

For all veneered and melamine finishes with grain, the grain runs continuously between the side panel and cover of Open units. Placing them next to or on top of veneered or melamine Lampo units with horizontal grain changes the direction of the grain and the colour tone.

OPENINGS



Drawer

Door

Drop-down

UPPER fronts: MINIMAL handle
LOWER fronts: PUSH-PULL

OPEN SIDEBOARDS WITH INTERMEDIATE OPEN UNITS

Sideboards finished with finished modular covers and front panels with exposed top edge use MINIMAL PROFILE OPENING, WHILE FRONT PANELS WITH TOP EDGE CONCEALED BY THE OPEN UNIT USE PUSH-PULL OPENING.

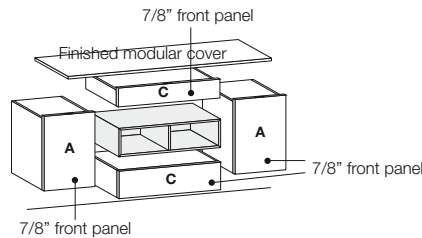
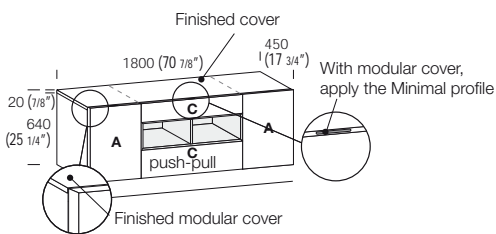

OPENINGS



Drawer

Door

Drop-down

UPPER fronts: MINIMAL handle
LOWER fronts: PUSH-PULL

Types

Hanging units

Depth 17 3/4"

BASE UNITS

Depth 17 3/4"

Types	H 5/8"	H 3 1/4"	H 4 3/4"	H 7 1/8"
P-Floor-standing foot	P1			
M-Methacrylate Sospendo		M1	M2	
C-Cylindrical Sospendo			C2	C3
S-Shaped Sospendo			S1	

Depth 18 5/8"

With external lighting with illuminated profile

Hanging units

Depth 17 3/4"

BASE UNITS

Depth 17 3/4"

Types	H 5/8"	H 3 1/4"	H 4 3/4"	H 7 1/8"
P-Floor-standing foot	P1			
M-Methacrylate Sospendo		M1	M2	
C-Cylindrical Sospendo			C2	C3
S-Shaped Sospendo			S1	

Depth 18 5/8"

With external lighting with illuminated profile

Storage units **Lampo Open**

STRUCTURAL FEATURES

Types

OPEN SIDEBOARDS WITH 4-SIDED FRAME

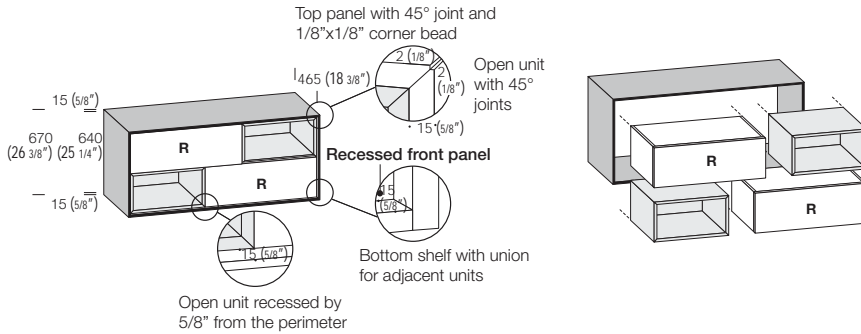

BASE UNITS				
Depth 18 3/8"-22 1/8"				
Types	H	H	H	H
	5/8"	3 1/4"	4 3/4"	7 1/8"
P-Floor-standing foot	P1			
M-Methacrylate Sospendo		M1	M2	
C-Cylindrical Sospendo			C2	C3
S-Shaped Sospendo			S1	
Depth 19 1/8"				
With external lighting with illuminated profile				

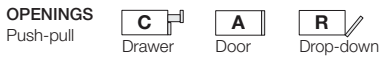

METHACRYLATE SPACER
Th. 1/2" for self-supporting compositions
D. 21 1/2" and 17 3/4"

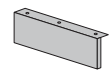

D	CODE	H 6 7/8" floor-standing	H 10 1/8" floor-standing	H 13 1/4" floor-standing
15 7/8"	CYDM400	41	44	59

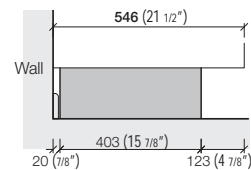
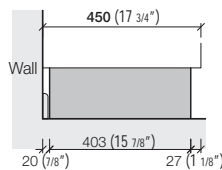

Floor-standing spacers should be placed at a maximum distance of 5 7/8" from the sides of the units above and their distance from the point at which they encounter the unit below should be no more than 35 1/2".

